

## Issue 12

In this issue, attach the T-VIS Intake Control System to the engine assembled up to Issue 11. This is an important component designed to maximise the performance of the 4 AGEU engine used in the AE86.

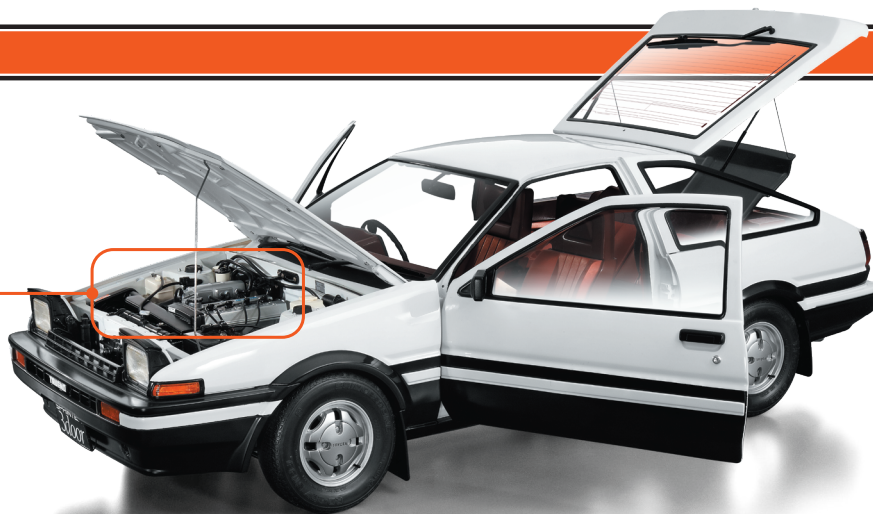

## Attach the T-VIS Intake Control System

※ In this guide "Left" or "(L)", and "Right" or "(R)", refer to the direction as viewed from the driver's seat.

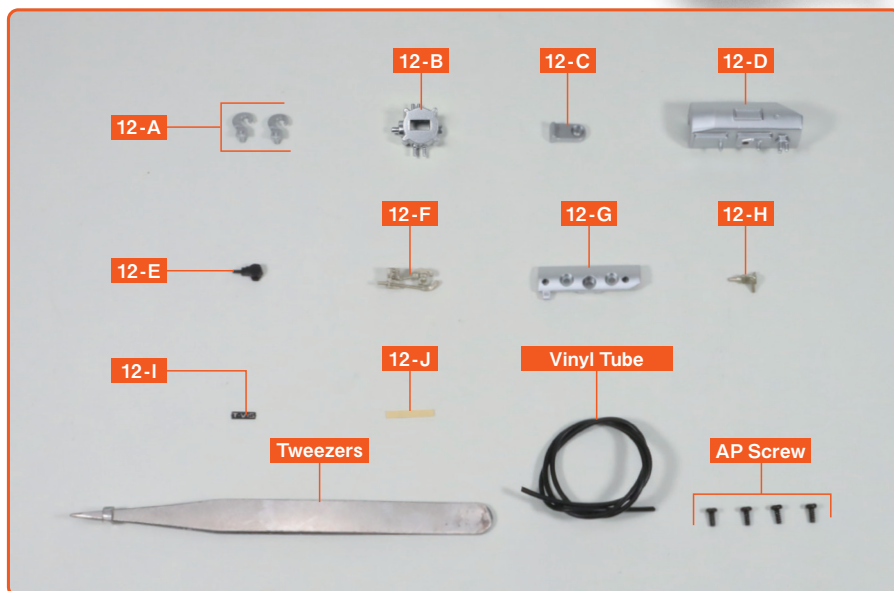

- 12-A** Hang-Up Hook×2
- 12-B** Throttle Body
- 12-C** Throttle Body Bracket
- 12-D** T-VIS Surge Tank (1)
- 12-E** Throttle Position Sensor
- 12-F** Accelerator
- 12-G** T-VIS Surge Tank (2)
- 12-H** Cold Start Injector
- 12-I** T-VIS Plate
- 12-J** Double-Sided Tape×1+1 spare
- Vinyl Tube
- Tweezers
- AP spare (1.7×4 mm)×4+spare

View the follow-along video



※Due to the model's design, the shapes of some parts may differ from those of the real vehicle.

### step 1 Prepare the wiring

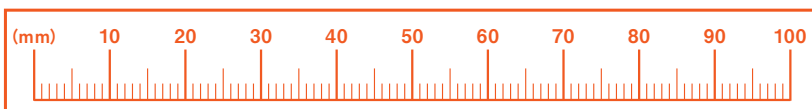

Cut the wiring to be connected in step 4 from the vinyl tube. Use the ruler on the left, or create a tool as shown in the photo below, and trim the wires to length with a craft knife or scissors.

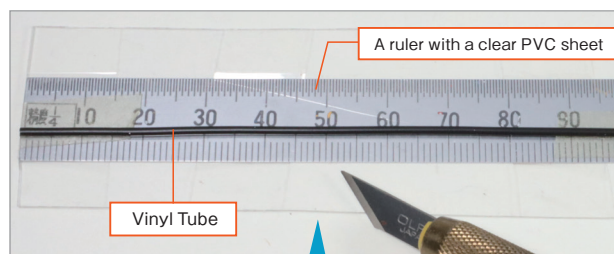
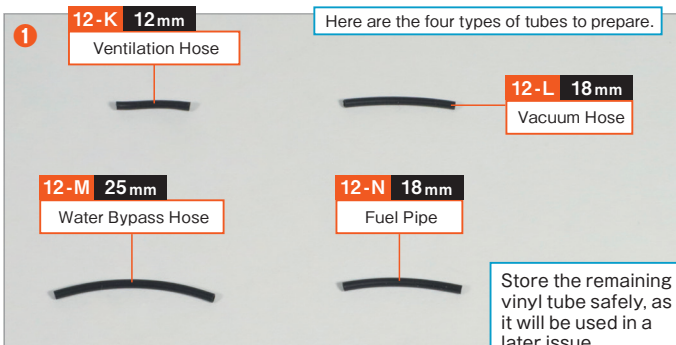

To prevent scratches, attach a clear PVC sheet to a ruler, temporarily fix the vinyl tube in place with double-sided tape, and cut it with a craft knife.

## step 2 Attach the Hang-Up Hook

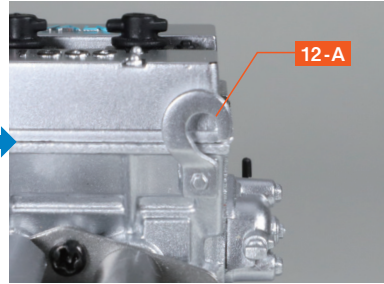
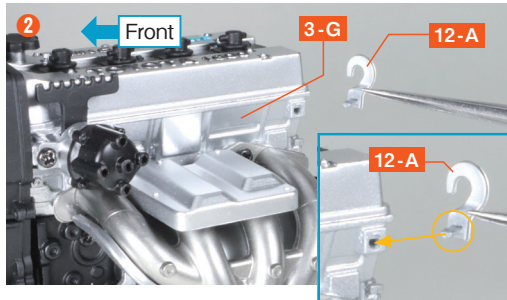

Prepare the Engine assembled up to Issue 11 and position it as shown. Align the hole on the left side of the **Cylinder Head 3-G** with the peg on the **Hang-Up Hook 12-A**, then press it into place.

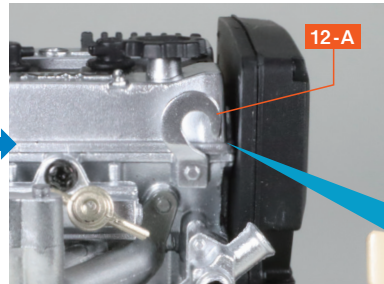
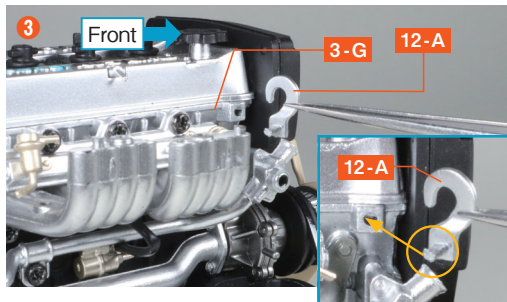

Turn the Engine to face the opposite direction. Align the hole on the right side of **3-G** with the other peg on **12-A**, then press it into place.

If **12-A** tends to come off during steps ②③, apply a small amount of all-purpose adhesive to its pegs before fitting it in.

## step 3 Assemble the T-VIS

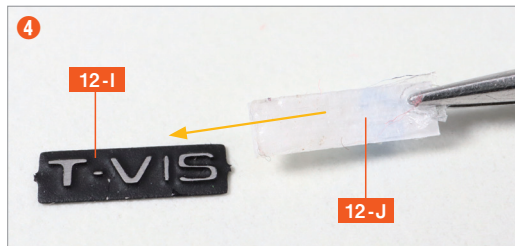

Cut one of the two pieces of **Double-Sided Tape 12-J**, peel off one backing sheet, and apply it to the back of the **T-VIS Plate 12-I**.

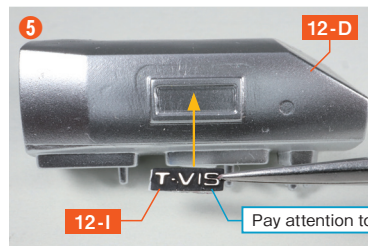

Peel off the remaining backing sheet from **12-J** and attach **12-I** to the **T-VIS Surge Tank (1) 12-D**.

Pay attention to the orientation

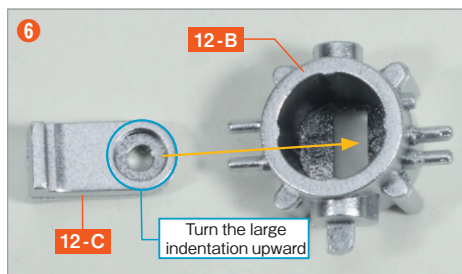

Insert the round end of the **Throttle Body Bracket 12-C** into the **Throttle Body 12-B**, then pull it through the square opening of **12-B** to the outside.

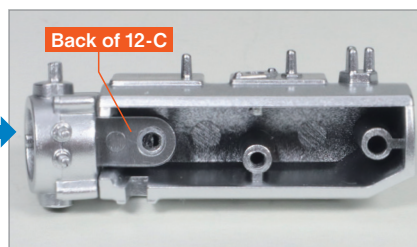
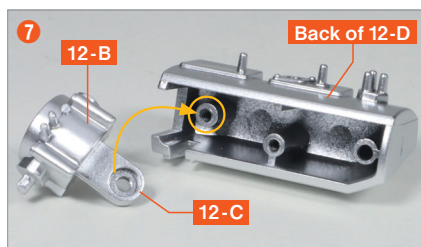

While holding **12-B** and **12-C** so they do not shift, align the recess in **12-C** with the peg of the screw hole on the back of **12-D**, and push them together.

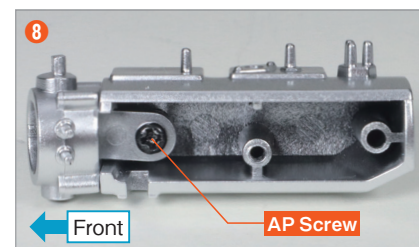

Secure with an **AP screw**.



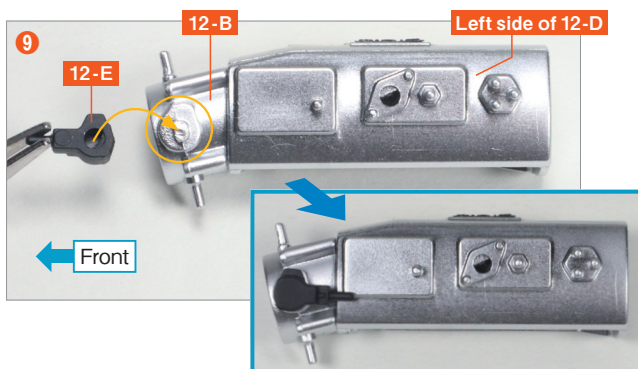

Align the projection on **Throttle Position Sensor 12-E** with the hole in **12-B**, then press it into place.

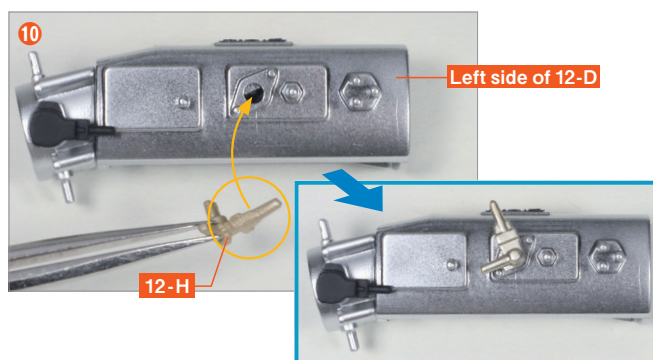

Align the shape of the hole on the left side of **12-D** with the projection on the **Cold Start Injector 12-H**, and press it into place.

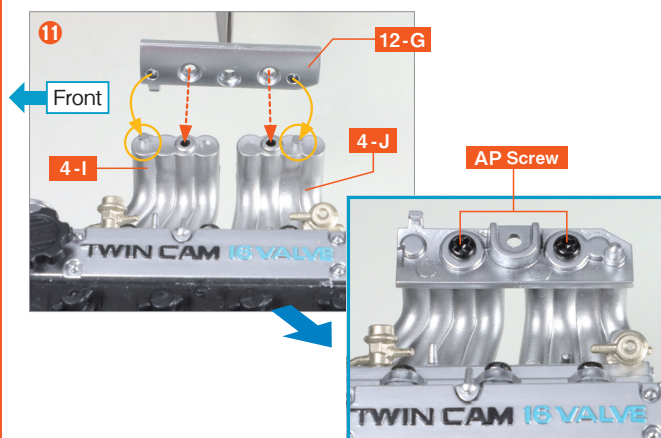

With the engine front facing left, align the four recesses on **T-VIS Surge Tank (2) 12-G** with the projections on **Intake Manifolds (L) 4-I** and **Intake Manifold (R) 4-J**, and secure with two **AP screws**.

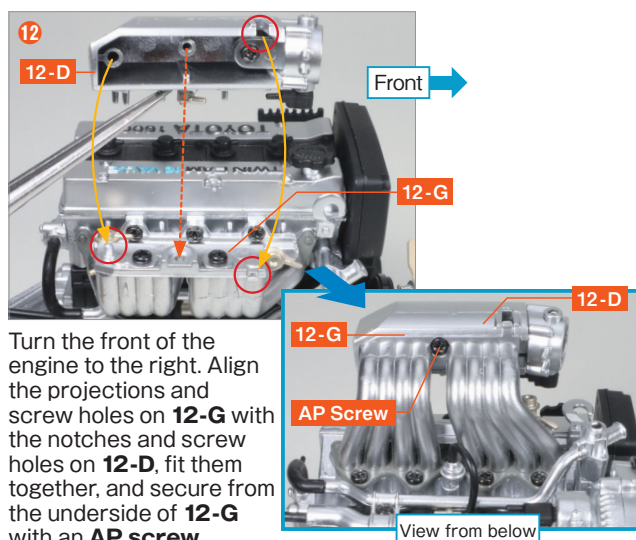

Turn the front of the engine to the right. Align the projections and screw holes on **12-G** with the notches and screw holes on **12-D**, fit them together, and secure from the underside of **12-G** with an **AP screw**.

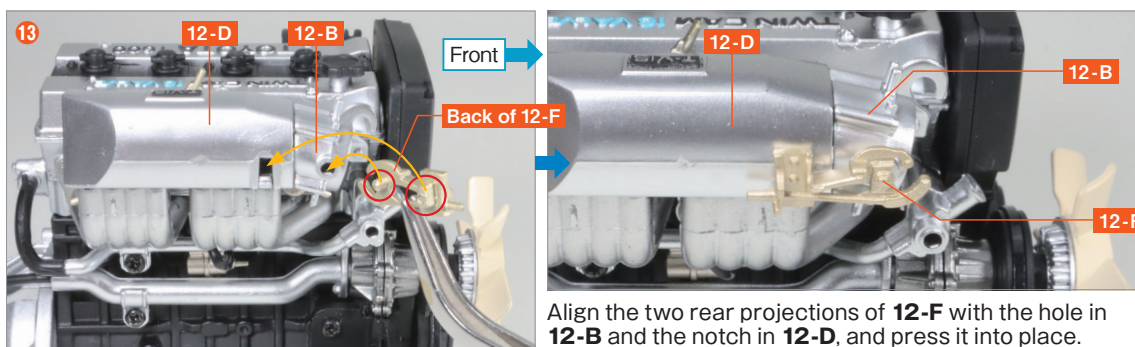

Align the two rear projections of **12-F** with the hole in **12-B** and the notch in **12-D**, and press it into place.

**Step complete**

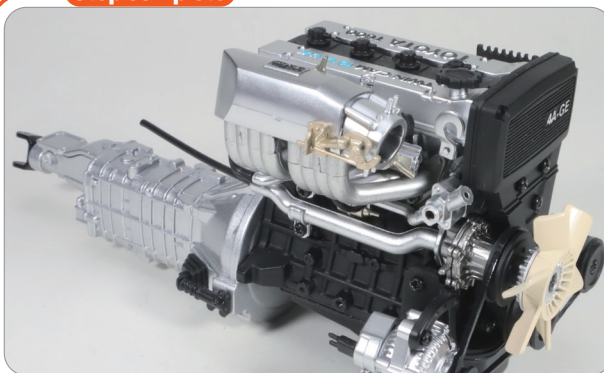



## step 4 Connect the Wires

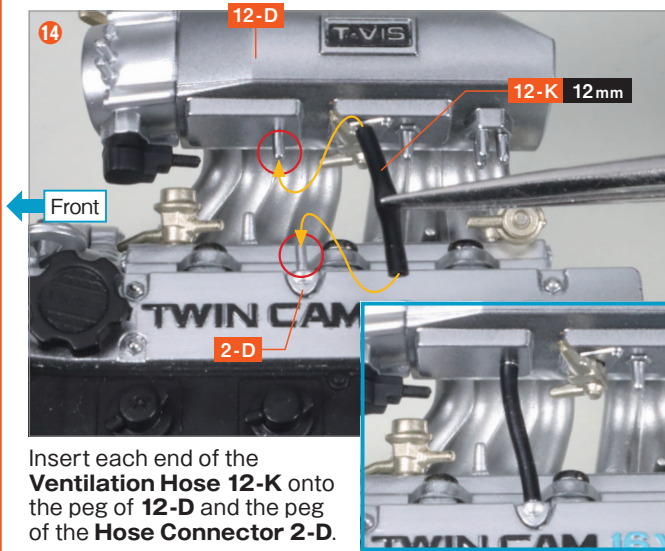

Insert each end of the **Ventilation Hose 12-K** onto the peg of **12-D** and the peg of the **Hose Connector 2-D**.

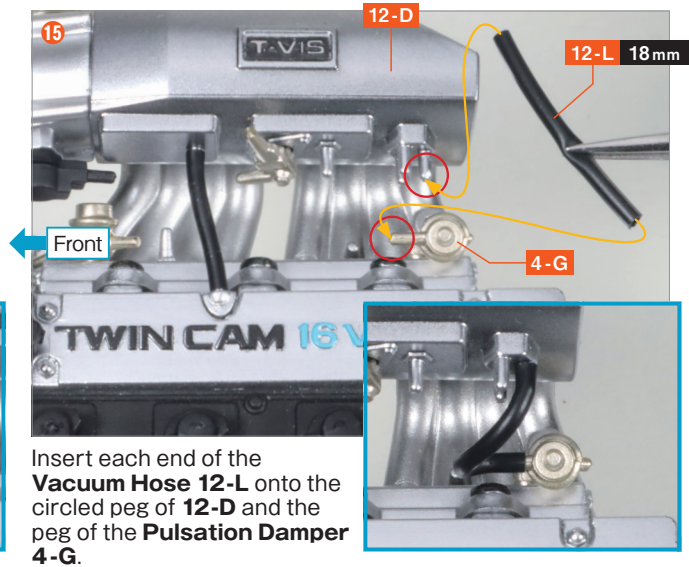

Insert each end of the **Vacuum Hose 12-L** onto the circled peg of **12-D** and the peg of the **Pulsation Damper 4-G**.

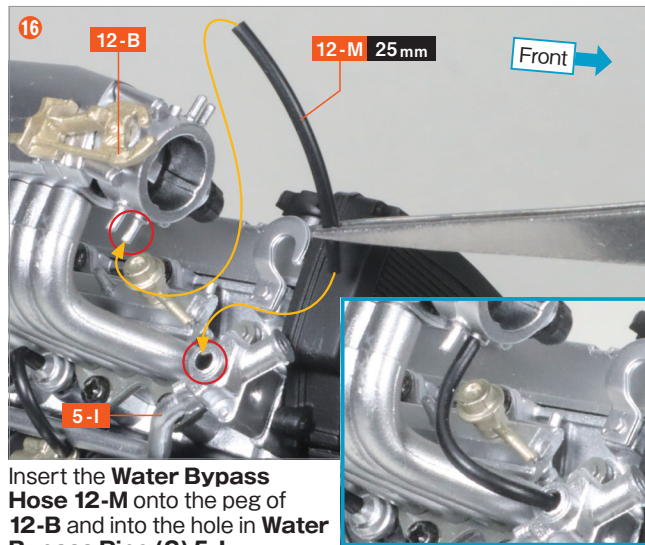

Insert the **Water Bypass Hose 12-M** onto the peg of **12-B** and into the hole in **Water Bypass Pipe (2) 5-I**.

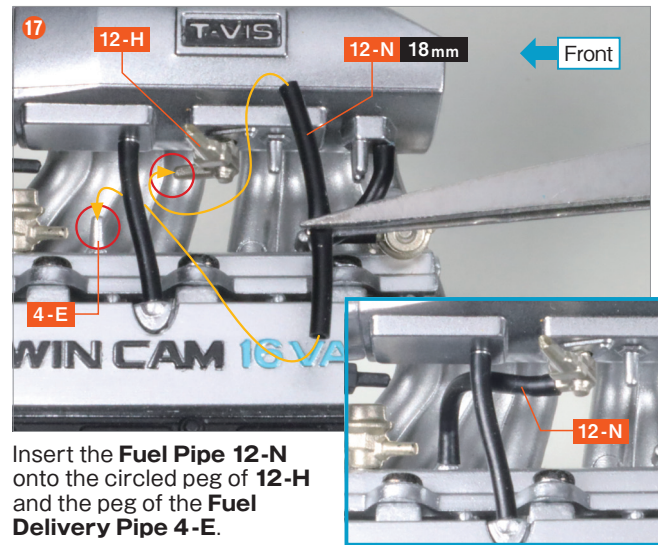

Insert the **Fuel Pipe 12-N** onto the circled peg of **12-H** and the peg of the **Fuel Delivery Pipe 4-E**.

## Complete

The assembly for Issue 12 is complete. With the T-VIS system and the surrounding wiring installed, the full picture of the 4AGEU engine is gradually coming into view. Keep the remaining vinyl tubing in a safe place, as it will be used in later issues. In Issue 13, we will connect the distributor and the plug-cable heads using the plug cables.

